

Typical Two-Way Road Narrows Operation

LEGEND

- Traffic Cone ●●●●
- Long. Safety Zone
- Lateral Safety Zone
- Works Area
- Sign Location & Orientation
- Taper

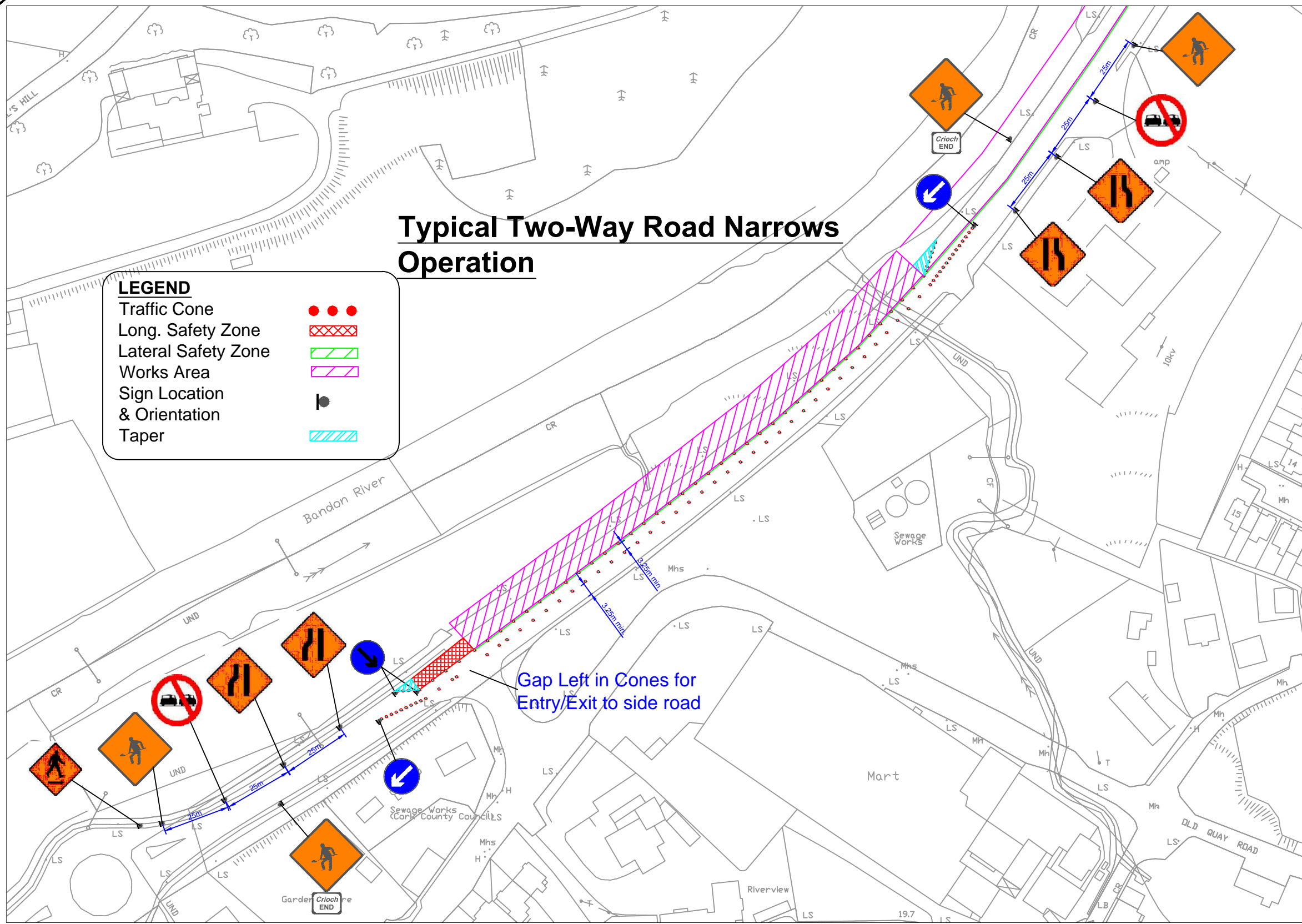

SITE SPECIFIC NOTES

Running Lane Width: 3.0m min (one way)

Cork County Council, Byrne Looby, An Garda Síochána shall be consulted to agree the final Traffic Management system so that safety zones and minimum lane widths are provided and maintained at all times.

'Overhead Cables' sign WK 062 will be used where overhead cables are present along the works route.

Exact sign positions to be agreed on site.

- WKS 071** SHOULD BE USED TO INDICATE THE PRESENCE OF A HUMP IN THE ROAD DUE TO THE ROADWORKS OR A TRAFFIC CALMING MEASURE
- WKS 072** MAY BE USED TO INDICATE THAT THERE IS AN UNEVEN SURFACE FOR VEHICLES USUALLY ASSOCIATED WITH THE DIFFERENT LAYERS OF SURFACING
- WKS 073** SHOULD BE USED TO WARN THAT THE DANGER OF VEHICLES SKIDDING IS GREATER THAN NORMAL. THE SIGN WILL BE USED WHERE TRAFFIC IS RUNNING ON A TEMPORARY SURFACE OR THE FINAL SURFACING HAS NOT YET BEEN LAID.
- WKS 074** SHOULD BE USED TO INDICATE THAT THERE IS A RISK OF AIRBORNE CHIPS OR STONES - LOOSE CHIPPINGS
- NO ROAD MARKINGS** SIGN NECESSARY TO WARN DRIVERS OF SOFT VERGES

| | |
|---------------------------|----------|
| | |
| Issued for Implementation | |
| Issued for Approval | 28.07.16 |
| Revision/Issue | Date |

Wills Bros Ltd
CIVIL ENGINEERING CONTRACTORS

BALLYLAHAN BRIDGE Tel: +353 (0)94 9256221
FOXFORD Email: www.willsbros.com
CO. MAYO.

| DESIGN PARAMETERS | | | MIN LANE WIDTH | CONE SPACING | | SAFETY ZONE | | | RATE OF TAPER | | TEMPORARY SIGNS | | | TRAFFIC MANAGEMENT SYSTEM | | |
|-------------------|----------------|--------------------|------------------------|------------------|---------------|--------------|-------------|------------------|----------------------------|-------------------|-------------------------------------|-----------------|---------------------|---------------------------|-----------------------|------------------------------|
| Road Level | Roadworks Type | Speed Limit (km/h) | Minimum Lane Width (m) | Longitudinal (m) | At Tapers (m) | Set Back (m) | Lateral (m) | Longitudinal (m) | Taper at Hard Shoulder (m) | Taper at Lane (m) | Distance between advanced signs (m) | Number of signs | Sign Visibility (m) | Method | Coned Area Length (m) | Maximum Traffic Flow (veh/h) |
| 2 | A | 50 | 3.0 | 6.0 | 1.0 | - | 0.5 | 25 | 45° | 45° | 25 | 4 | 50 | Road Narrows | 70m approx. | - |

| | |
|---|--|
| Client Office of Public Works | Scale NTS |
| Project Bandon Flood Relief Main Works Contract | Date 28.07.16 |
| | Drawn KC Checked WT |
| Title Traffic Management Layout Glasslinn Road | Project No: Drawing No: FRS-TM-005 |